FIFTH EPOCHAL FELLOWSHIP

529 Wrightwood Avenue
Chicago, Illinois 60614 U.S.A.
312-327-0424

Dear Friends,

Come to the wild West. Breathe the fresh pine-scented air. Walk in the mountains. Sit down by a mountain stream. Listen... and commune with God.

The Fifth Epochal Fellowship, formerly URANTIA Brotherhood, is still hard at work on the 1990 International Conference, in Snowmass/Aspen, Colorado, entitled "Walking with God." The conference program has been specifically created to stimulate spiritual growth and to bring readers of *The Urantia Book*, from all over the world, closer together. Activities have been designed for the entire family as well as for the individual. And nothing can match the serene beauty of the Colorado Rocky Mountains.

Our International Conferences have traditionally been memorable experiences for readers of *The Urantia Book*. These conferences only come once every three years. And the 1990 Conference promises to be the largest gathering ever, with people coming for fellowship and worship from all around the world.

We want you to be there too. Enclosed is a registration packet describing all the features and information that you'll need to attend the conference. Please read the *Information Booklet* carefully before filling out the proper forms, and send in your deposits wherever applicable. We need to have your registration no later than April 30. You'll notice that accommodations will be booked on a first come, first served basis.

These are exciting times throughout the world, and even more so for all of us who are dedicated to the work of our Heavenly Father.

Peace & Blessings

Sincerely,

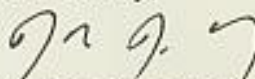

John D. Hay, Chairman
1990 International Conference

PARENT INFORMATION

ORIENTATION - (Saturday 5:00 - 5:45 PM / Wildwood Hotel- Max Park Room)
A brief welcome and time for questions & answers

PROGRAM CAPACITIES - The nursery and teen programs are full to capacity. A waiting list is at the registration desk in case openings appear due to cancellations

CAMP SNOWMASS - A few openings in the Camp Snowmass program are available at \$11.00/ 3 hr. session. Sue Way, Director, will be at the Timbermill Childcare Facility (lower level, Timbermill Building) on Saturday between 3:00 - 5:00 PM to sell these available sessions, to receive part-time campers daily schedules, and to answer any questions. The Timbermill Building is at the end of the mall, below the Silvertree Hotel. Campers can wear their bathing suits to the afternoon sessions to relieve a crowded dressing room. Bring towels and sunscreen (label belongings, please).

SCHEDULE CHANGE - Please note that the Teen Bike Ride will be Tuesday afternoon, and the Aspen Mountain Gondola Ride and Hike on Wednesday afternoon.

NURSERY STAFF - Infants will be cared for by Joanne Sorenson (group leader) and Kirsten Harden (assistant). Toddlers will be cared for by Kathy Waver (group leader), Maria Radatus (AM assistant), and Shawna Rohrabach (PM assistant).

PHONE NUMBERS - In case you need to contact the nursery, childcare or teen programs:

Sonnenblick #4 - 923-2449
Sonnenblick #6 - 923-2518
Camp Snowmass - 923-2085, Ext. 4570
Mountain Chalet - 923-3900

LATE PICK-UP - Please be courteous to the hard-working staff. Pick up your child promptly! Late fees will be assessed.

POOL RULES - All pools are swim at your own risk. Children under 12 years old MUST be supervised by an adult. All pools are for the guest of that hotel, except the main SRA Pool (below the mall, by the Pokolodi). This pool can be used by all visitors to Snowmass. The SRA Pool will be crowded between 3:30 - 5:00 PM, when the Camp Snowmass children swim.

PLAYGROUND - There is a playground behind the SRA Pool.

CHILDREN AT ADULT PRESENTATIONS - Please be courteous to others. Remove disruptive or distracting children until they become quiet. Sit near the back unless you are certain your children can remain quiet.

ALTITUDE ADJUSTMENT - Children need plenty of rest, more water or liquids than ever, and sunscreen.

**FIFTH EPOCHAL FELLOWSHIP
CAMP SNOWMASS DAILY SCHEDULE**

PIONEERS: AGES 5-6

ADVENTURE SEEKERS: AGES 7-12

These campers will follow the same basic schedule but will be grouped according to their age.

MORNING SCHEDULE: 8:30 - 12:00

8:30 - 9:30 Drop off - sign in (children will have the opportunity to explore our nature center, paint, and get acquainted with the teachers and the other campers)

9:30 - 12:00 Special activity, art project, games, and snack

AFTERNOON SCHEDULE: 3:00 - 6:00

3:00 - 4:00 Special activity, games, get ready for swimming

4:00 - 5:15 Swim Time (water games)

5:15 - 6:00 Snack and group time (art, drama, or stories)

BRING: Bathing suit, towel, sunscreen, coat, and wear tennis shoes. Please label all belongings.

HIGHLIGHTED THEMES

SUNDAY: SOUTH OF THE BORDER (Visit Mexico through language development, arts, games, food, and story)

MONDAY: NATIVE AMERICANS (Nature hike, scavenger hunt, Indian sign language, Indian craft and costumes will be explored)

TUESDAY: OUR NORTHERN FRIENDS and OUR ISLAND FRIENDS (We'll explore the life and culture of our warm weather friends and our cold weather friends through music, dance, games, crafts, and special activities)

WEDNESDAY: FREEDOM DAY (Red, White and Blue, Freedom activities, Peace games, and American culture)

THURSDAY: OUT OF AFRICA (Explore Africa through dance, games, stories, and African Mask Design)

ALL ACTIVITIES ARE AGE APPROPRIATE AND DEPICT THE CULTURES WE'LL EXPLORE. EACH DAY WILL INCLUDE GAMES, STORIES, ART PROJECTS, SPECIAL CULTURAL ACTIVITY, SWIMMING AND SNACK.

**PLEASE FILL OUT THE ENCLOSED LIABILITY FORM AND RETURN IT TO
CAMP SNOWMASS, 42 BADGER RD, CARBONDALE, COLORADO, 81623**

1990 International Conference

For Readers of *The Urantia Book*

June 30 - July 5

ACTIVITIES FORM

All activities below must be reserved in advance

The Snowmass Village Concierge is coordinating recreational activities on specific days for our group at special discount rates. Please consult the *Information Booklet* for a full description of each of the activities listed below. For your convenience, you may enclose this form and your deposit in the same envelope containing your Lodging reservations that is mailed to Snowmass Resort Association, or you may mail it directly to The Village Concierge. Your Activities Reservation and deposit must be received by June 1, 1990.

- Use this form to reserve your space on the following activities. To properly calculate the AMOUNT due, multiply the number of people (adults and /or children) times the cost of each particular activity. Your reservation will be made based upon the amount paid. Please take the time to carefully calculate your payment and to be aware of minimum ages where they apply. It is very important to correctly enter the number of participants in the "#Adult/#Child" categories. Numbers are limited so please sign up soon.
- A check or money order, made out to The Village Concierge, for a **deposit of 50% of your total amount** must accompany your request. The remaining balance will be paid at on-site registration on Saturday, June 30. You will be mailed a receipt and follow-up information. This information will detail times, dates and other material pertinent to your booked activities. Reservations may be canceled within 10 days of the scheduled activity. After that time a cancellation fee of up to 100% of your payment may be charged, depending upon the activity. Please make a personal copy of this form before it is mailed. If you have any questions, or would like further information on a specific activity, please write or phone The Village Concierge, P.O. Box 6248, Snowmass Village, CO 81615, U.S.A., phone: (303) 923-5400.

HALF DAY WHITEWATER RAFT TRIP

Monday, July 2, 1:30 to 6:00

Number of Adult(s) _____ @ \$35.00 = \$ _____

Number of Children 6 to 15 _____ @ \$30.00 = \$ _____

HALF DAY GLENWOOD HOT SPRINGS

Tuesday, July 3, 1:30 to 6:00

Number of Adult(s) _____ @ \$19.00 = \$ _____

Number of Children 6 to 15 _____ @ \$17.00 = \$ _____

TWO HOUR HORSEBACK TRAILRIDE

Sunday, July 1, 1:00 to 3:00

Number of Adult(s) _____ @ \$22.00 = \$ _____

Number of Children over 8 _____ @ \$22.00 = \$ _____

Wednesday, July 4, 1:00 to 3:00

Number of Adult(s) _____ @ \$22.00 = \$ _____

Number of Children over 8 _____ @ \$22.00 = \$ _____

WALKING/SHOPPING TOUR OF ASPEN

Wednesday, July 4, 1:30 to 4:30

City Bus fare collected upon departure

Number of Adult(s) _____ @ No charge

Number of Children 6 to 15 _____ @ No charge

TOTAL AMOUNT \$ _____

Enclose a deposit of 50% of total amount \$ _____

Last Name _____ First Name _____

Address _____ City _____

State/Province _____ Postal Code _____ Country _____

Phone (Home) _____ (Work) _____

Make Check Payable to: *The Village Concierge* Check Enclosed ☐ Money Order Enclosed ☐

I wish to charge my ☐ Mastercard ☐ Visa

Credit Card # _____ Expiration Date _____

Name on Card _____ Signature _____

RETURN ACTIVITIES FORM WITH PAYMENT IN THE ENCLOSED WHITE ENVELOPE TO:

Snowmass Resort Association • P.O. Box 5566 • Snowmass Village, CO 81615 U.S.A.

or mail directly to The Village Concierge • P.O. Box 6248 • Snowmass Village, CO 81615 U.S.A.

Walking with God

Mit Gott Gehend

Walking with God

1990 International Conference

Walking with God PROGRAM CALENDAR

JUNE 30	JULY 1	JULY 2	JULY 3	JULY 4	JULY 5
SATURDAY	SUNDAY	MONDAY	TUESDAY	WEDNESDAY	THURSDAY
	7:00-7:30 Morning Meditation	7:00-7:30 Morning Meditation	7:00-7:30 Morning Meditation	7:00-7:30 Morning Meditation	7:00-7:30 Morning Meditation
	7:00-9:00 Breakfast	7:00-9:00 Breakfast	7:00-9:00 Breakfast	7:00-9:00 Breakfast	7:00-9:00 Breakfast
	9:00-12:15 Childcare	9:00-12:15 Childcare	9:00-12:15 Childcare	9:00-12:15 Childcare	9:00-12:15 Childcare
	9:15 Opening Ceremonies	9:15 Program Begins	9:15 Program Begins	9:15 Program Begins	9:15 Program Begins
	Keynote Speaker Steve Dreier <i>Walking with God</i>	9:30 Arts Presentation	9:30 Arts Presentation	9:30 Arts Presentation	9:45 Arts Presentation
		9:45-10:30 Plenary Speaker Carol Hay	9:45-10:30 Plenary Speaker Alison Gardner	9:45-10:30 Plenary Speaker David Robertson	
					10:00-10:45 Closing Ceremonies Larry Mullins <i>Walking with God</i> Synthesis
11:00 am - 10:00 pm Registration at Conference Center		10:45-11:45 Presentation: <i>Recognition of Religious Living in Others</i>	10:45-11:45 Presentation: <i>Reflective Meditation on Cosmic Meanings</i>	10:45-11:45 Presentation: <i>Avoidance of Selfishness</i>	10:45-11:45 Worship
	12:00-2:00 Lunch	12:00-2:00 Lunch	12:00-2:00 Lunch	12:00-2:00 Lunch	
	12:00-3:30 Free Time	12:00-3:30 Free Time	12:00-3:30 Free Time	12:00-3:30 Free Time	
	3:00-6:00 Childcare	3:00-6:00 Childcare	3:00-6:00 Childcare	3:00-6:00 Childcare	
	3:30-4:30 Presentation: <i>Cultivating Sensitivity to Divine Values</i>	3:30-4:30 Presentation: <i>Sharing One's Spiritual Life with One's Fellows</i>	3:30-4:30 Presentation: <i>Worshipful Problem Solving</i>	3:30-4:30 Presentation: <i>Living as in the Presence of God</i>	
	4:45-5:45 Second Session: <i>Refusal to Presume on Divine Mercy</i>	4:45-5:45 Second Session	4:45-5:45 Second Session	4:45-5:45 Second Session	
	6:00-6:30 Worship Service	6:00-6:30 Worship Service	6:00-6:30 Worship Service	6:00-6:30 Worship Service	
6:00-8:00 Dinner	6:00-8:00 Dinner	6:00-8:00 Dinner	6:00-8:00 BBQ Dinner	6:00-8:00 Dinner	
7:30 Welcome Social					
8:00 Entertainment	8:00 Entertainment	8:00 Entertainment	8:00 Square Dance Band Fireworks	8:00 Entertainment	
10:00-12:00 Club UB Entertainment	10:00-12:00 Club UB Entertainment	10:00-12:00 Club UB Entertainment	10:00-12:00 Club UB Entertainment	10:00-12:00 Club UB Entertainment	



What's happening

at the Hotel



Wildwood

Pippin's, our Steak & Lobster Restaurant and Lounge, located above the lobby, begins serving cocktails at 5:00 PM and serves dinner from 6:00 until 10:00 PM daily. We do offer Room Service from 6:00-10:00 PM, if you desire, call Ext. 111. A recently adopted Town Ordinance requires that our dining area be non-smoking. Our lounge is the designated smoking area and dinner can be served in the lounge for those who would like to smoke during dinner.

Hotel van transportation to the Airport is available every day from 6:15 AM to 10:00 PM. PLEASE SIGN UP AT THE FRONT DESK IN ADVANCE OR CALL EXT. 500 FOR RESERVATIONS.

For the protection of your valuables, we recommend that you utilize a safety deposit box at the Front Desk. There is no fee for this service.

Humidifier rentals are available for \$3.00 per day. See Front Desk or call Ext. 500.

24 hour Valet Service is available Monday-Friday. A laundry/valet bag and ticket are located in your top left dresser drawer. Please drop off at the desk by 9:00 AM for delivery the following day.

We have an exchange library in the Lobby. Drop off the books you've read for someone else to read and pick up a new one for yourself.

Our pool, saunas and hot tub are open daily from 9:00 AM until 10:00 PM. GLASS CONTAINERS ARE NOT ALLOWED IN THE POOL AREA. Contact the Front Desk for plastic cups. A life guard is not on duty. Children under 13 must be accompanied by their guardian.

Ice machines are located on the third floor straight out of the elevator and on the west wing by room 348. Vending machines are located on the second floor exiting the elevator and on the west wing by room 248.

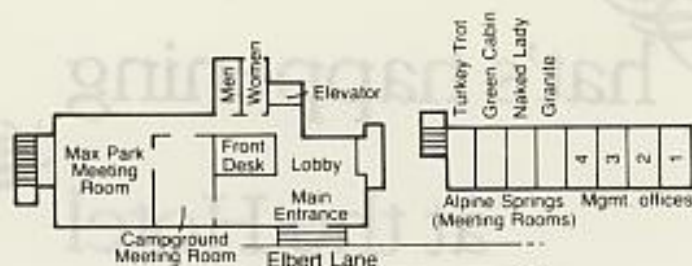
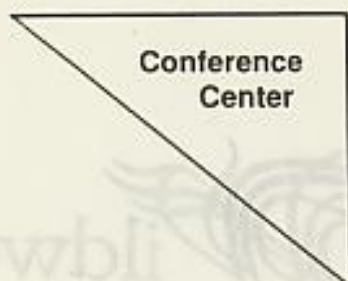

Ground Floor

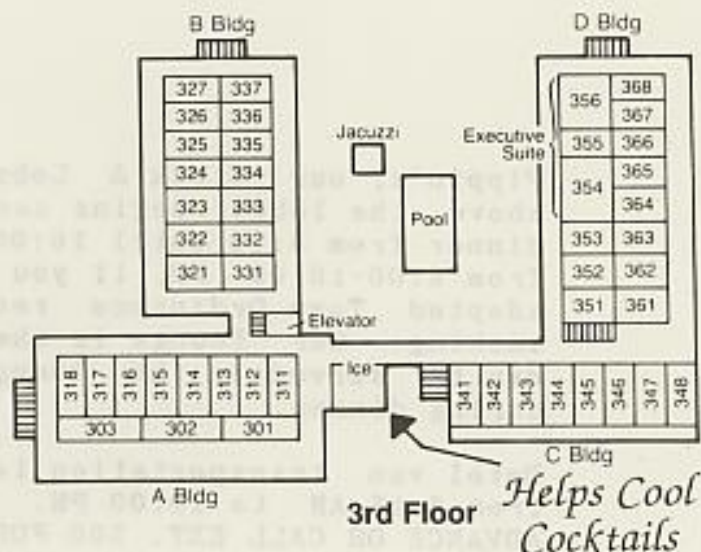
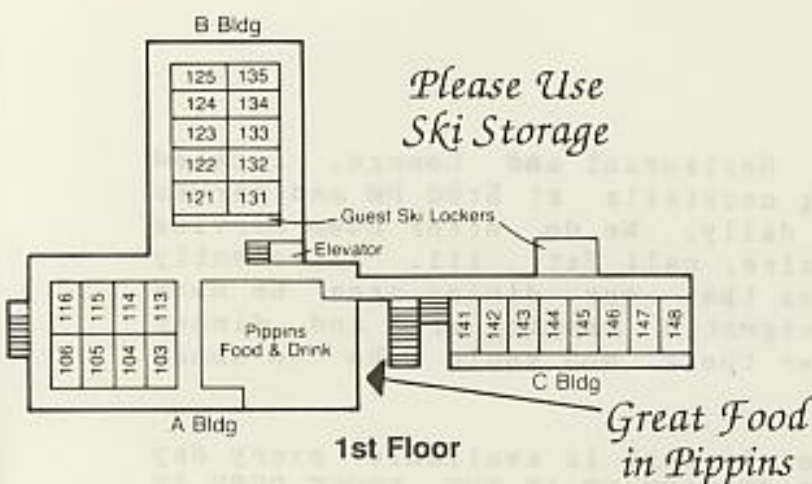

*Pool, Jacuzzi & Sauna
Open 9 a.m. - 10 p.m.*

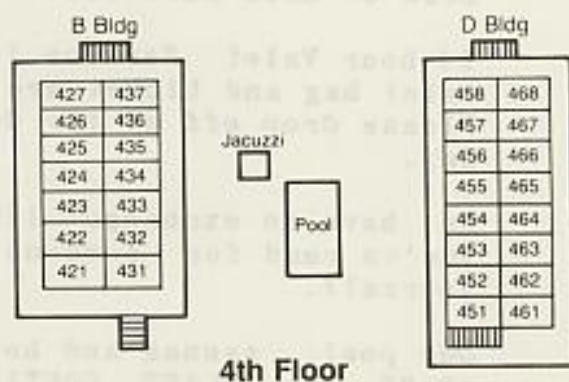
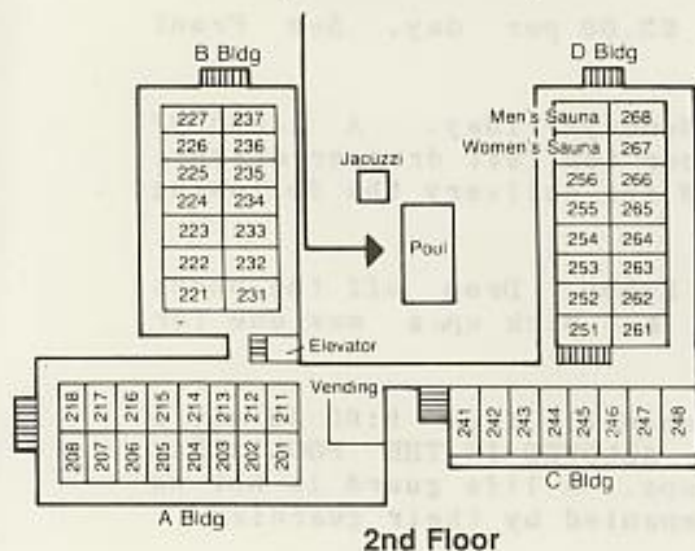

4th Floor



HOTEL WILDWOOD



On the Mall
In the Village • At Snowmass



Once Upon A Mountain

a most inviting hotel was born — Hotel Wildwood. Nestled in a charming mountain village, with views of magnificent snow-capped peaks, the hotel is dedicated to the pleasure of its guests.

Good Things Begin to Happen from the time you arrive. You're transported from the airport in our courtesy van...and receive a warm welcome in our cheerful lobby lounge with its cozy bar and inviting fireplace. Here the ambience sets the tone for a vacation that's sure to bring you back again and again.



HOTEL
WILDWOOD

Come taste the magic.



Lay Your Head
Upon Our Pillows

after a day of play in the high country. You'll appreciate the extra measure of comfort our rooms provide. Some have private balconies. Others overlook our courtyard pool and Jacuzzi. Sumptuous touches include special accessories and cosmetics for a soothing bath or shower, plus remote color cable TV.

HOTEL
WILDWOOD

The way it should be.



HOTEL
WILDWOOD

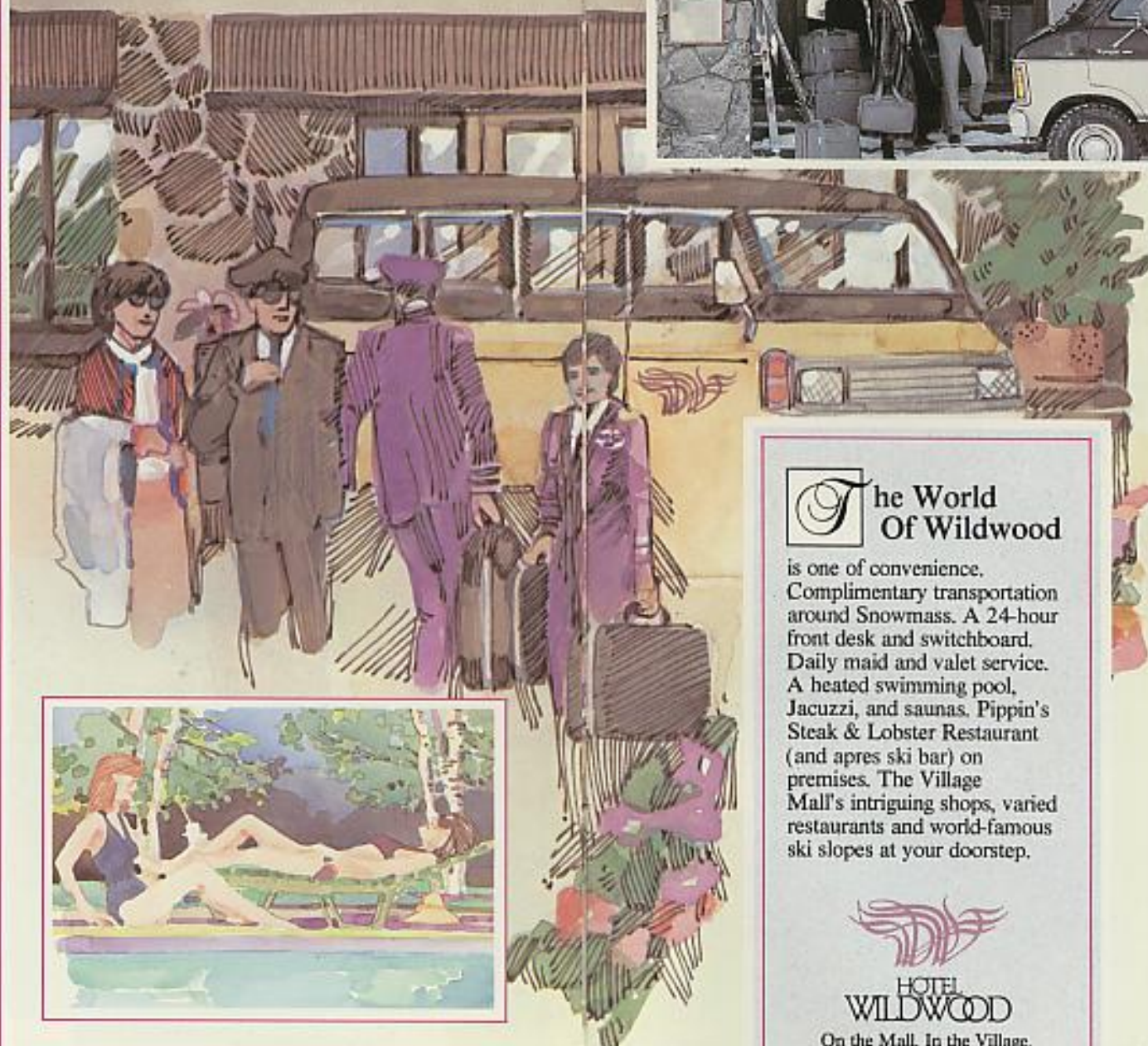

The World Of Wildwood

is one of convenience. Complimentary transportation around Snowmass. A 24-hour front desk and switchboard. Daily maid and valet service. A heated swimming pool, Jacuzzi, and saunas. Pippin's Steak & Lobster Restaurant (and apres ski bar) on premises. The Village Mall's intriguing shops, varied restaurants and world-famous ski slopes at your doorstep.



HOTEL
WILDWOOD

On the Mall. In the Village.



**nowmass:
A Mountain Of Family Fun.
A Four-Season Vacation
And Meeting Center.**

Of course, the skiing on Snowmass and three other famous mountains will bring you back. But that's just for starters. The warmer seasons bring golfing, tennis, hiking, fishing, kayaking, rafting, bicycling, four-wheeling and horseback riding. You can also experience the summer Aspen Music Festival, ballet, theatre, art galleries and enough other diversions to fill an entire book about the perfect vacation. For these reasons and more, Hotel Wildwood is also the perfect environment for conferences, with facilities for up to 250 people. And we have direct access to the new Snowmass Conference Center for your meetings of up to 1400.

The Ease Of Getting Here

Drive, take the train or take the bus, and enjoy the incredible Rocky Mountain scenery. Or fly. There are frequent flights between Aspen/Snowmass and Denver's Stapleton International Airport (many of them on large jets). And the number of direct flights from major American cities continues to grow. Your travel agent can provide complete current information.



On the Mall. In the Village. At Snowmass
Box 5037 40 Elbert Lane
Snowmass Village, Colorado 81615
In Colorado, 303-923-3550
Outside Colorado, 1-800-445-1642



P.O. Box 5037

Snowmass Village, Colorado 81615

" A Small Hotel with Grand Hospitality "
WINTER RATES - 1990-91

Low Season	Holiday* Season	Value Season	Regular* Season
11/21-12/14/90 3/20/91-4/15/91	12/15/90- 1/1/91	1/2/91- 2/1/91	2/2/91- 3/29/91

Standard Rooms

(2 Doubles, 1 Queen or 1 King Bed)	\$ 86.00	\$175.00	\$ 127.00	\$ 161.00
---------------------------------------	----------	----------	-----------	-----------

Deluxe Rooms

(2 Queens or 1 King) Most have Views & Balconies.	\$ 96.00	\$185.00	\$ 137.00	\$ 171.00
---	----------	----------	-----------	-----------

Suites

(1 Queen, and Sofa Bed) Some have Fireplaces, Kitchen and/or Jacuzzi Tub.	\$135.00	\$245.00	\$ 200.00	\$ 221.00
--	----------	----------	-----------	-----------

*7 Night minimum may be required during certain periods.

- Check-out 11:00 AM/Check-in 4:00 PM.
- Rates include daily maid service-exclusive use of all recreational facilities (Pool, Saunas & Jacuzzi).
- Complimentary Continental Breakfast in lobby from 7AM-9AM daily & Courtesy Airport Shuttle 6AM-11PM.
- All rooms have Mini-refrigerators, Coffee makers and remote Cable TV.
- Interior connecting rooms available upon request.
- Fine Dining available with Children's menu at Pippin's Steak & Lobster Restaurant, located in the hotel.
ROOM SERVICE AVAILABLE EVENINGS.
- All rates quoted are single or double occupancy. Children twelve (12) and under stay free in parent's room. Extra adult charge, Fifteen dollars (\$15) per person per night. Rollaways are charged at \$10 additional per night.
MAXIMUM OCCUPANCY (4) PER ROOM.
- A DEPOSIT of \$200 per room is required within ten (10) days of the request for reservation. FINAL PAYMENT is due THIRTY (30) days prior to the date of arrival.
- CANCELLATIONS: If cancellations are made more than thirty (30) days prior to the date of arrival, the deposit will be refunded, less a \$25 processing fee per room. If cancellations are made less than 30 days prior to the date of arrival, no refund will be made, unless the space is rereanted for the entire period of the reservation, in which case, full payment will be refunded, less a \$25 processing fee per room.
- Rates and taxes subject to change without notice.
- 2.0% Civic Assessment and 7.2% Sales Tax is not included.
- NO PETS ALLOWED.
- Group Rates available upon request.
- RESERVATIONS: Call your Travel Agent or call Hotel Wildwood

303-923-3550	Hotel Information
800-445-1642	Reservations Nationwide
800-833-1603	Reservations in Colorado
303-923-4844	FAX

REV. 1/1/90



P.O. Box 5037

Snowmass Village, Colorado 81615

" A Small Hotel with Grand Hospitality "
1990 SPRING, SUMMER, & FALL

SPRING/FALL

4/15/90-5/1/90

9/15/90-11/20/90

SUMMER

6/2/90-8/15/90

Standard Rooms

(2 Doubles, 1 Queen or 1 King Bed)

\$ 70.00

\$ 84.00

Deluxe Rooms

(2 Queens or 1 King)

most have balconies and views.

\$ 70.00

\$ 95.00

Suites

(1 Queen and sofa bed).

Some have fireplaces, kitchen and/or

Jacuzzi tub.

\$110.00

\$130.00

- Check-out 11:00 AM/Check-in 4:00 PM.
- Rates include-daily maid service-exclusive use of all recreational facilities (Pool, Saunas & Jacuzzi).
- Courtesy transportation to & from Aspen Airport (6AM-11PM)
- All rooms have Mini-refrigerators, Coffee makers and remote Cable TV.
- Interior connecting rooms available upon request.
- Fine Dining available with Children's menu at Pippin's Steak & Lobster Restaurant, located in the hotel.

ROOM SERVICE AVAILABLE EVENINGS.

- All rates quoted are single or double occupancy. Children twelve (12) and under stay free in parent's room. Extra adult charge, Ten dollars (\$10) per person per night. Rollaways are charged at \$10 additional per night.

MAXIMUM OCCUPANCY (4) PER ROOM.

- A Deposit of one night's lodging per room is required within ten (10) days of the request for reservation. Final payment is due upon arrival.
- **CANCELLATIONS:** If cancellations are made more than fourteen days prior to the date of arrival, the deposit will be refunded. If cancellations are made less than fourteen days prior to the date of arrival, full payment will be refunded, less a \$25 processing fee.

- Rates and taxes subject to change without notice.
- 2.0% Civic Assessment and 7.2% Sales Tax is not included.

NO PETS ALLOWED.

- Group Rates available upon request.
- Reservations: Call your Travel Agent or call Hotel Wildwood.

303-923-3550

800-445-1642

800-833-1603

303-923-4844

Hotel Information

Reservations Nationwide

Reservations in Colorado

FAX

REV. 1/1/90



HOTEL WILDWOOD

"A SMALL HOTEL WITH GRAND HOSPITALITY"

Post Office Box 5037 Snowmass Village, Colorado 81615 • 303-923-3550
800-445-1642 (Nationwide) • 800-833-1603 (Colorado)
303-923-4844 (Fax)

CHARLES MONTGOMERY
5912 WHEELHOUSE LANE
AGOURA HILLS CA 91301

TODAY'S DATE: 04/27/90
RESERVATION #: 11063

ARRIVAL DATE: 06/30/90
DEPARTURE DATE: 07/05/90
NUMBER OF NIGHTS: 5
NUMBER OF PEOPLE: 3
TOTAL CHARGES: \$ 413.47
DEPOSIT: \$ 76.00
BALANCE DUE: \$ 337.47
CREDIT CARD #: 5277013700032475
RESERVATION TAKEN BY:

THANK YOU FOR YOUR DEPOSIT OF: 76.00

THE BALANCE DUE IS: 337.47

RESERVATION POLICY:

FINAL PAYMENT IS DUE UPON ARRIVAL.

CANCELLATIONS: If cancellations are made more than fourteen (14) days prior to the date of arrival, the deposit will be refunded. If cancellations are made less than fourteen days prior to the date of arrival, full payment will be refunded, less a \$25 processing fee per room.

All rates quoted are single or double occupancy. Children twelve (12) and under stay free in parent's room. Extra adult charge ten dollars (\$10) per person per night. Rollaways are charged at \$10 additional per night - MAXIMUM OCCUPANCY (4) PER ROOM.

Sorry, NO PETS! Check-in time is 4:00 P.M. Check-out time is 11:00 A.M.
We're looking forward to having you as our guest!

Date	Description	Total	Tax	Balance
04/27/90	Deposit by Chk 1041	-76.00	0.00	-76.00



snowmassSM

C34859

CHANGE

04/27/90

cindy

CHARLES MONTGOMERY
5912 WHEELHOUSE LANE

AGOURA HILLS CA 91301

WE ARE PLEASED TO ACKNOWLEDGE YOUR RESERVATION
FOR FIFTH APOCHAL FELLOWSHIP
AT: HOTEL WILDWOOD

ARRIVAL:	06/30/1990	DEPARTURE:	07/05/1990
5 NIGHTS			
3 PEOPLE FOR	5 NIGHTS AT \$ 76.00 A NIGHT	\$	380.00
PLUS	% TAX (2.0% C.A., + 7.2% tax)	\$	35.49
	SERVICE CHG	\$	
	LODGING TOTAL	\$	415.49
	TOTAL AMOUNT DUE	\$	415.49
	DEPOSIT DUE DATE		04/25/1990
	DEPOSIT AMOUNT	\$	76.00
	AMOUNT RECEIVED	\$	76.00

IF PAYMENTS ARE NOT RECEIVED AS SCHEDULED, THE SPACE YOU
ARE HOLDING WILL BE RELEASED.

CONFERENCE POLICIES:

DEP: ONE NIGHTS LODGING AT TIME RESERVATION IS MADE

FNL: UPON CHECK IN

CXL: IF CXLD 30 DAYS OR MORE, FULL REFUND LESS \$25.00, LESS
THAN 30 DAYS PRIOR, LOSE DEPOSIT UNLESS RERENTED, THEN \$25.00

PLEASE REMIT PAYMENTS TO:

SNOWMASS RESORT ASSOCIATION
CENTRAL RESERVATIONS
P.O. BOX 5566
SNOWMASS VILLAGE, CO. 81615

comments 2 DOUBLE BEDS PLEASE
REPRINTED CONF.

IMPORTANT REMINDER

VACATION PROTECTION PACKAGE

offered by

The Snowmass Resort Association

Dear Valued Customer,

In reviewing your Travel Itinerary, we've noticed that you haven't purchased our Vacation Protection Package. Snowmass Chamber Resort Association is committed to providing you with the best possible service. Because of this commitment, we've designed a special program which will protect you and your travel investment before and during your trip.

The information on the reverse side will give you more details about this important element of your trip. Please take the time to review it carefully and then you or your travel agent can contact us immediately at 1-800-322-3245. The package may be purchased anytime up to the final payment date for your trip.

Have a Safe and Enjoyable Trip!





snowmasssm

For as low as \$16 per person, you can protect the investment you made in your Vacation Package by purchasing Trip Cancellation and Interruption coverage.

 **Trip Cancellation and Interruption** - Pays for loss due to unforeseen circumstances or death, injury, illness of you, a Family Member, or a Traveling Companion.

For only \$20 per person, you can fully protect yourself by purchasing the Vacation Comprehensive Package. The package includes the following coverages.

 **Accidental Death & Dismemberment** - Pays up to \$10,000 for a covered accidental death or dismemberment 24 hours a day while you are on your trip.

 **Emergency Assistance** - Pays up to \$2,500 for covered evacuation and transportation expenses as directed by a doctor to the nearest adequate medical facility.

 **Medical Expense** - Pays up to \$2,500 for a covered accident or sickness and emergency dental on your trip, with no daily limits or deductibles.

 **Baggage & Travel Documents** - Pays up to \$500 for covered items lost, stolen, or broken on your trip. Includes borrowed or rented property.

 **TRAVEL GUARD Assistance** - 24 hour emergency medical help... all just a phone call away!

To purchase, call us at 1-800-322-3245. Both plans may be purchased up to the final payment date for your trip.

After you've purchased the Vacation Protection Package a full explanation of the benefits, conditions and exclusions will be sent to you.

The Snowmass Resort Association

Vacation Protection Package

is administered by:

**INSURE
AMERICA**

... a division of
TRAVEL GUARD® International

SCENE I opens in Corinth a short time after Joshua, the Damascus Scribe made his visit. The lives of the various characters have all been touched by the liberating message he brought. The story is based upon pages 1474 and 1475 of *The Urania Book*. Meanwhile, Caligastia and a rebellious Midwayer still plot and plan to thwart the teachings of the Master.

SCENE II opens in modern times. The life-giving teachings of Jesus, as revealed through the Spirit of Truth and *The Urania Book*, give inner strength to all who have living faith. Caligastia and his rebellious midwayer vainly attempt to corrupt these followers.

MUSICAL NUMBERS

SCENE I

Overture	
"Power From Within"	Roman Centurion & Chorus
"People of the World"	Roman Judge & Chorus
"Your Song"	Solonia & 1st Trio
"A Life Worth Living"	Martha & Solonia
"Welcome Back Jesus"	Brian & Chorus
"Set Me Free"	Levi & Joanna
"As He Passed By"	Caligastia & Midwayer

SCENE II

"Livin' in de Faduh's Mansion"	Ensemble & Chorus
"As He Passed By" Reprise	Caligastia & Midwayer
"Channel 7"	Trucker
"Feel Like I'm Coming Home"	Runaway
"Cosmic Compass"	Cult Leader & Chorus
"His Love in You, His Love in Me"	4th Follower, Maureen
"When you Call"	The Followers & 2nd Trio

Finale: Chorus

"As He Passed By"
"Livin' in de Faduh's Mansion"

THE CAST (In order of appearance)

SCENE I

Rebellious Midwayer	Dan Young
Caligastia	Paul Barby
Roman Centurion	Tom Allen
Quartet	Tom Allen, Bill Allen, Rusty Aldridge & Larry Geis
Roman Judge	Larry Geis
Solonia (the Miller's Wife)	Barbara Hester
1st Trio	Linda Bynum, Waldine Stump, Susan Wright-Aldridge
Martha (the Innkeeper)	Susan Wright-Aldridge
Brian (the Traveler from Britain)	John Laskman
Levi (the Criminal)	Bill Allen
Joanna (Levi's Wife)	Linda Bynum

SCENE II

Trucker	Don Gardner
Runaway	Carol Hay
Cult Leader (Rex)	Rusty Aldridge
1st Follower (Janet)	Karen Johnson
2nd Follower (Brent)	John Lange
3rd Follower (Pam)	Coleen Holden
4th Follower (Maureen)	Susan Ransbottom
2nd Trio	Barbara Hester, Carol Hay, Linda Bynum

THE MUSICIANS

Keyboards/Assistant Conductor	Susan Wright-Aldridge
Guitar & Bass	Bill Granstaff
Percussion	Terry Pursell
Keyboards & Effects	Richard Randall
Keyboards	Carol Hay
Flute	Bill Allen

THE CHORUS

SOPRANO

Patricia French
Barbara Hester
Shana Hunt
Jeannine Inquiere
Cecilia Lampley
Judith Mathieson
Eve McMahon
Susan Ransbottom
Sue Smith
Waldine Stump
Sue Tennant

ALTO

Nancy Allen
Chrystilyn Biek
Linda Bynum
Kelly Chapman
Lynn Chapman
Tomnie Clendenning
Carol Hay
Coleen Holden
Karen Johnson
Mary Lou Kerr
Ellen Montgomery

TENOR

Bill Allen
Tom Allen
Steve Bartley
Eric Coash
John Hales
John Laakman
Chic Montgomery

BASS

Rusty Aldridge
Fred Fasha
Don Gardner
Larry Gels
John Hay
John Lange
Delmar Milne

THE STAFF

Executive Producer Susan Wright-Aldridge
Director Paul Barby
Producer Barbara Hester
Technical Director Lenny Cowles
Musical Director Eileen Lawrence
General Manager Berkeley Elliott
Costumes Frankie Goodman, Blanche Fasha,
Charleen Morrow & Karen Johnson
Set & Hand Props Diane Menard
Make-up & Hair Karen Johnson
Musician Productions Supervision Bill Granstaff
Stage Manager Rusty Aldridge

POWER FROM WITHIN

Performed
at the
Fifth Epochal Fellowship
Snowmass Conference
"Walking With God"
Snowmass, Colorado
July 4, 1990
8:00 PM

Created by the Oklahoma Urantia Book Readership

PROGRAM SCHEDULE

CONFERENCE CENTER

SUNDAY WALKING WITH GOD

- 9:15** Program Begins (Anderson Ballroom - Capacity 1200)
- 9:30-10:00 Introduction and Welcome - JOHN D. HAY - Conference Chairman
Announcements and Prayer
- 10:00-10:15 Greetings from Fifth Epochal Fellowship - DAVID ELDERS - President
Arts Presentation
- 11:00-12:00** Keynote Speaker
STEVE DRIER WALKING WITH GOD
- 3:30 - 4:30** CULTIVATED SENSITIVITY TO DIVINE VALUES
DAN MASSEY LOVE, VOLITION, AND SUPREMACY
(Anderson Capacity 300) Accommodations of the self to reality is a matter of continuing spiritual communion. Universe events consequent to the bestowal of Michael provide the mechanisms by which each true son's will, united with that of the Father, achieves effective action and liberation from the limitations of time and space. Manifestations attendant on the spiritualized exercise of intentional volition span the entire range of Supreme function on finite reality. 1)MD/H; 2)AP/L/E; 3)A
- BILL & KAYE COOPER SEEING WITH GOD'S EYES
(Hoaglund Capacity 300) An exploration utilizing a simple technique which enables individuals to open themselves to a greater experience of the divine values in any situation. Participants will then share with each other as a method of socializing the experience for greater understanding and insight. 1)L; 2)E; 3)A
- CHICK MONTGOMERY WALKING WITH GOD ... AN EXPERIENTIAL WORKSHOP
(Erickson/Carroll Capacity 175) Bring your spiritual seeds and your mental plow, and this workshop will cultivate a harvest of increased sensitivity to truth, beauty and love. Share a group prayer for personal and world peace, a short talk on cultivating sensitivity, group discussion on values important to participants, and a prayer of affirmation to incorporate all these values into individual experience. 1)L; 2)E/AP; 3)A
- TOM CHOQUETTE IN SEARCH OF THE DIVINE VALUES WITHIN US: BECOMING GOD-LIKE
(Janss Capacity 75) What are divine values? How do these values associate with one another and why? What effect do divine values have on free will creatures? How can we practically apply these divine values in the hustle and bustle of our daily lives? 1)L; 2)E/AP/L; 3)A/F/C

Key: 1) Level of Comprehension of concepts presented in The Urantia Book needed to understand presentation: L=Low; MD=Medium; H=High.
2) Style/Format of Presentation: E=Experiential; AP=Audience Participation; L=Lecture
3) Type of Audience: F=Families; A=Adults; C=Children

4:45-5:45

REFUSAL TO PRESUME ON DIVINE MERCY

TERRY KRUGER

REFUSAL TO PRESUME ON DIVINE MERCY

(Anderson
Capacity 300)

Look out yuppies, you're maxing out your Divine Mercy Credit Card ... a perspective shared by Terry Kruger. 1)MD; 2)L/AP; 3)A

MARY DALY

RECONCILIATION AND GROWTH

(Hoaglund
Capacity 300)

Our certainty of God's mercy must not lead us to be indifferent to the reality of sin and the requirements of growth in our own lives. Participants will look at what the Book says about sin, about confession, about bearing fruit and the commonly-accepted social expressions of presumption. 1)L; 2)L/AP; 3)A

SCOTT FORSYTHE

FROM CHAOS TO GLORY or WHY GOD EXPECTS YOU TO GET UP IN THE MORNING AND PARTICIPATE IN THE GROWTH OF THE SUPREME

(Erickson/Carroll
Capacity 175)

We live in a time of transformation and great evolutionary change. Across the face of the planet people, both individually and collectively, are making decisions to break the bonds of fear, to heal their lives and relationships, to commit themselves to service. The consequences of these decisions are individually transforming and have the potential, in the aggregate, to significantly move humanity towards its "new and unrevealed" planetary destiny. If we hold these planetary developments to be of significance, then we must commit ourselves individually by decisions and actions to support their growing manifestation. 1)L; 2)L/AP; 3)A

NANCY JOHNSON

IN SEARCH OF THE ERROR SO GREAT

(Janss
Capacity 75)

"Sometimes error is so great that its rectification by revelation would be fatal to those slowly emerging truths which are essential to its experiential overthrow" (554-5). There was something the revelators couldn't tell us back in 1934. But did they precondition us to recognize it at a later date? Would we continue to presume on divine mercy if we fully realized that living Supremacy is within our reach? Is A Course in Miracles an addendum to The Urantia Book? 1)L/MD/H; 2)L; 3)A

MONDAY

RECOGNITION OF RELIGIOUS LIVING IN OTHERS AND SHARING ONE'S SPIRITUAL LIFE WITH ONE'S FELLOWS

9:15

Program Begins (Anderson Ballroom - Capacity 1200)

9:15-9:30

Announcements and Prayer

9:30-9:45

Arts Presentation

9:45-10:30

Plenary Session

CAROL HAY

THE ART OF SHARING

10:45 - 11:45

RECOGNITION OF RELIGIOUS LIVING IN OTHERS

JOHN LANGE

RECOGNIZING SERVICE DYNAMICS IN OTHERS

(Anderson
Capacity 300)

We grow spiritually by recognizing religious living in others. We're told in Paper 5 that "religion ... is a living and dynamic experience of divinity attainment predicated on humanity service" (pg. 66). This workshop focuses on looking at the service dynamics of individual lives by picking figures such as Mother Teresa, Anwar Sadat, et. al., and discussing their services - politically, religiously, or through an art form. 1)MD; 2)E/L; 3)A

SARA
BLACKSTOCK

(Hoaglund
Capacity 300)

RECOGNIZING SPIRITUAL QUALITIES IN KIDS

Beginning with an 8-minute slide presentation of children of all ages, this workshop asks, what eyes do we see through as we look for spiritual characteristics in children. The emphasis is on the "hidden" characteristics. Lots of audience sharing of thoughts, feelings, and experiences. 1)L/MD; 2)E/AP/L; 3)A (parents/teachers)

JEFF WATTLES

(Erickson/Carroll
Capacity 175)

GROWING UP WITH JESUS: NEW PERSPECTIVES ON DEVELOPMENTAL PSYCHOLOGY

An exposition of the problem of sharpening our intuition (p. 192, 1119c) regarding social and spiritual fruits (1126). This will be a presentation of work by Fowler (and Erikson, Kohlberg & Gilligan as time allows) focusing on Jesus' developmental stages. 1)L; 2)AP/L; 3)F/A/C

MELISSA WELLS

(Janss
Capacity 75)

SPIRITUAL SHARING - PATHWAY TO GOD

This presentation will focus on progressive growth and spiritual transformation achieved through discovering God within, and sharing the experience with others. Many references will be made to the spiritual life of Jesus. 1)L; 2)E; 3)A

3:30-4:30

SHARING ONE'S SPIRITUAL LIFE WITH ONE'S FELLOWS

GARD JAMESON
AND FLORENCE
JAMESON, M.D.

(Anderson - Capacity 300)

FELLOWSHIP WITH GOD, NOW AND FOREVER

This talk will center on the importance of sharing the inner life with God and then sharing that spiritual life with one's fellows. The focus will be on how a disciplined approach to knowing God better through prayer and worship manifests itself in daily life. 1)L; 2)E; 3)F

JOHN ROPER

(Hoaglund
Capacity 300)

AS WE PASS BY - SHARING THE SPIRITUAL LIFE SPREADING GOOD CHEER

This presentation will explore Jesus' style of spreading good cheer as he passed by in both his public and private ministries. There will be outlines of some of the how-to's of spreading good cheer and its relation to the golden rule. Personal experiences will be shared, and practice of methods of spreading good cheer in our daily lives. 1)L; 2)AP; 3)F

BILL & KAYE
COOPER

(Erickson/Carroll
Capacity 175)

SPIRITUAL SUPPORT GROUPS

This workshop will focus on experiencing the spiritual joy and fulfillment of sharing our spiritual lives with each other - love, forgiveness, acceptance, understanding and the discovery of a spiritual brother or sister. The techniques used are simple and easily taken home to enrich everyday life. 1)L; 2)E; 3)A

SATU SHIVO

(Janss
Capacity 75)

SHARING ONE'S SPIRITUAL LIFE WITH ONE'S FELLOWS

This is a workshop on one way of using small groups to help us keep in mind the inner guidance and at the same time practicing non-judgmental listening, spiritual sharing and loving support. 1)L; 2)E; 3)A

4:45-5:45

SHARING ONE'S SPIRITUAL LIFE WITH ONE'S FELLOWS

BOBBIE DREIER

(Anderson
Capacity 300)

ACCEPTING UNCONDITIONAL LOVE

The major obstacles to accepting God's love unconditionally are doubt, fear and pride. The presenter will share her struggle to overcome these obstacles. 1)MD; 2)AP/L; 3)F

BOB SLAGLE

(Hoaglund
Capacity 300)

RETURNING TO THE FAMILY COUNCIL PRACTICES OF THE ANDITES

Family meetings as recommended by The Urantia Book from Paradise down to Urantia with practical guidelines and role-playing. 1)L; 2)E/AP/L; 3)F/A

EARLENE GREEN (Erickson/Carroll Capacity 175)	I WOULDN'T TAKE NOTHING (ANYTHING) FOR MY JOURNEY THUS FAR This presentation focuses on the influence of Earlene's Thought Adjuster in getting her from a rural area in Florida amidst poverty, to where she is today. She will briefly touch on the Christianization of the black slaves, the incorporation of black culture and Christianity, how it affected her at age 10 when she "got religion" and the varied paths in her continued search for God. Earlene will even sing a few songs! 1)L; 2)L; 3)F/A
CHUCK BURTON (Janss Capacity 75)	TADPOLES, BUTTERFLIES, AND LIGHTSITY This presentation will emphasize the limitless number of opportunities and ways each of us has to share our inner lives with our fellow men. That, in fact, there exists no rigid formula or prescription, but rather, we are free to explore our spirituality in our own unique way - utilizing our special talents, experience, and the guidance of the indwelling spirit. 1)MD; 2)E/L; 3)F/A
TUESDAY	REFLECTIVE MEDITATION ON COSMIC MEANINGS AND WORSHIPFUL PROBLEM SOLVING
9:15	Program Begins (Anderson Ballroom - Capacity 1200)
9:15-9:30	Announcements and Prayer
9:30-9:45	Arts Presentation
9:45-10:30	Plenary Session
ALISON GARDNER	COSMIC CHOICE IN EVERYDAY LIFE
10:45-11:45	REFLECTIVE MEDITATION ON COSMIC MEANINGS
DAVID ELDERS	EXPERIENCING THE GOD IN ANOTHER
(Anderson Capacity 300)	The focus will be on the power of meditating on the cosmic significance of words which convey an idea so that the possibility to "know" and experience the living meaning behind the words is, or can be, actualized. One example is the link between the Son and the Word. 1)MD; 2)E/AP/L; 3)A
BOB SCHUER	PUTTING AN EYE TO THE KEYHOLE OF ETERNITY
(Hoaglund Capacity 300)	An invitation to look with the eye of faith on your position on the planet, in the system, in the constellation, in the local universe, in the minor and major sectors, in Havona, on Paradise and beyond -to meditate on your pathway to the Father. 1)MD; 2)E; 3)F
DAVID GLASS	COSMIC CONSCIOUSNESS, REALITY AND PURPOSE
(Erickson/Carroll Capacity 175)	Coordination of the mortal microcosm of matter, mind, spirit and personality with cosmic matter, mind, spirit and personality; registry of all reality in the mind, including the process of reflective meditation on cosmic meanings and the self-discovery of meanings and purposes in the individual and in the universe. 1)MD/H; 2)L; 3)F/A
FRANCYL GAWRYN	DISCOVERING COSMIC MEANINGS THROUGH PERSONAL STORY AND SONG
(Janss Capacity 75)	A seminar with audience participation through storytelling and group singing. 1)L; 2)AP; 3)F/A

3:30-4:30

WORSHIPFUL PROBLEM SOLVING

BETH BARTLEY

AN OFFER TOO GOOD TO REFUSE

(Anderson
Capacity 300)

"The law of the universe is: Ask and you shall receive; seek and you shall find." (1838) Jesus went even further when he said, "If you are ever in doubt as to what you would ask of the Father, ask in my name and I will present your petition." (1639) I take these instructions literally. When I have a problem or situation to deal with I ask for help, and sometimes even ask for help in asking for help. 1)L; 2)L; 3)F

MEREDITH
SPRUNGER

PRAYERFUL PROBLEM SOLVING

(Hoaglund
Capacity 300)

This presentation addresses problem solving in the context of experience and learning, beginning with rational-empirical problem solving and then probing the nature and extent of spiritual assistance available through prayer and worship. 1)MD; 2)L; 3)A

HARRY McMULLEN

JESUS' PRINCIPLES AND CAESAR'S MONEY

(Erickson/Carroll
Capacity 175)

A businessman's view of how spiritual power can turn the wheels of material success. 1)L/MD/H; 2)E/AP; 3)A

CAROLYN KENDALL

DEALING WITH THE ROTTEN STUFF THAT HAPPENS TO SWEET FOLKS LIKE US

(Janis
Capacity 75)

The presenter focuses on breaking down problems and applying solutions by utilizing the five following processes: Identifying types of problems; educating ourselves about causes; material preventive maintenance; spiritual preventive maintenance; Jesus and other experts. 1)L/MD; 2)AP; 3)F/A/Teens

4:45-5:45

WORSHIPFUL PROBLEM SOLVING

LYNN KULIEKE

BE YE PERFECT

(Anderson
Capacity 300)

Presentation's focus is not so much about doing the Father's will as it is about just "being." Soul attitude is the important aspect here and how that attitude lends itself to action. The workshop will be done partly in two languages, Spanish and English, with maybe a little French here and there. 1)L; 2)AP/L; 3)A/older children

MARVIN GAWRYN

WORSHIPFUL PROBLEM SOLVING: ACTIVATING THE SUPERCONSCIOUS MIND

(Hoaglund
Capacity 300)

What does worship do to us inside? How does it change our emotional climate? How does loving God dissipate fear? What is the anatomy of a problem? What are solutions and where do they originate? How can prayer set the stage and garner the results of worshipful problem solving? We will share and consult The Urantia Book on these and related questions. 1)L/MD; 2)AP; 3)A

EILEEN LAURENCE

ETHICAL BEHAVIOR IN OUR DAILY LIVES

(Erickson/Carroll
Capacity 175)

Using quotes from The Urantia Book on ethics and morality, Eileen will lead a discussion on how we bring the teachings into our daily personal interactions. She will also refer to recent studies discussed in "Mapping our Moral Domain" (Gilligan, Ward, Taylor), which looks at gender differences in moral behavior and ethical thinking. 1)MD; 2)AP; 3)F/A

GLORIANN HARRIS

I BELIEVE GOD MADE ME FOR A PURPOSE ... Eric Liddell

(Janis
Capacity 75)

The emphasis here will be on decision-making based on spiritual value systems. Reference material comes from The Urantia Book (1287). Personal decisions which have been illuminated by sincere worship, glorified by intelligent love, and consummated in brotherly service. 1)L; 2)L/E; 3)A

WEDNESDAY AVOIDANCE OF SELFISHNESS AND LIVING AS IN THE PRESENCE OF GOD

9:15 Program Begins (Anderson Ballroom - Capacity 1200)

9:15-9:30 Announcements and Prayer

9:30-9:45 Arts Presentation

9:45-10:30 Plenary Session

PATRICK YESH VISUALIZING AND AFFIRMING YOUR MORONTIA SOUL SELF-IMAGE SO YOU CAN WALK IN THE PRESENCE OF GOD AND AVOID SELFISH ACTION

10:45-11:45 AVOIDANCE OF SELFISHNESS

MO SIEGEL SEVEN PRACTICAL STEPS TO SELFLESS SERVICE

(Anderson Capacity 300) After reading The Urantia Book, you've probably found your spiritual values far ahead of your ability to live them. Don't feel frustrated, we all suffer from the same problem. But the book gives us directions on how you can advance heavenward by serving others here on earth. During this session, you'll learn seven practical steps you can implement tomorrow to multiply your giving power while increasing your inner joy. 1)L; 2)L; 3)A/Late Teens

ERROL & ROCHELLE STRIDER IN HIS PRESENCE - THE TOOLS, THE DIFFICULTIES, THE FEELING, THE EXPERIENCE

(Hoaglund Capacity 300) This program will focus on what it takes to live daily in the presence of God, what keeps us from this experience and how to deal with these blocks. Artistic expression will be included to help us access God's presence in the moment. 1)L/MD; 2)E/AP/L; 3)A

JIM JOHNSTON AVOIDANCE OF SELFISHNESS

(Erickson/Carroll Capacity 175) An inquiry into: What is selfishness? What forms does it take? Why "avoid" selfishness, why not choose selflessness? How to avoid selfishness. 1)L; 2)E/AP/L; 3)A

MARILYN KULIEKE WORKING TO RESOLVE THE DYNAMIC TENSION BETWEEN SELFISHNESS AND SELFLESSNESS

(Janss Capacity 75) The focus of this presentation is the exploration of two competing values - the material spirit of selfishness and the spiritual bestowal of selflessness. The group will explore these two values using the life of Jesus as one example, and determine approaches that might be suitable for resolving the tension which is brought about by the struggle between material and spiritual values. 1)L; 2)AP/L; 3)A

3:30-4:30

LIVING AS IN THE PRESENCE OF GOD

BRENT ST. DENIS

PRACTICE MAKES PERFECT

(Anderson
Capacity 300)

A practical look at the part which good habits can play in the day-by-day, moment-by-moment search for deeper communion with God. We start the mortal life as perfect but unconscious beings ... throughout this life we have the opportunity to become progressively more perfect as conscious ascenders. We will look at ways to discipline the mind through the inculcation of good habits which can assist us to focus on the moment and opportunities at hand. 1)MD; 2)E/AP/L; 3)A

ERROL & ROCHELLE
STRIDER

SELFISHNESS AS AN IDENTITY CRISIS

(Hoaglund
Capacity 300)

This presentation will be exploring the root cause of selfishness - separation from God and fear of God's love and abundance, and how it manifests in our behavior, attitudes and relationship to one another and to the things of this world. 1)L/MD; 2)E/AP/L; 3)A

JIM McNELLY

ON EARTH AS IT IS

(Erickson/Carroll
Capacity 175)

Peace on earth, peace with the earth, peace with God, ourselves, our parents, our families, the Bible, the church, the government, the schools, the environment, work, with everything. Let's experience God's will on earth as it is in Heaven. 1)MD; 2)L; 3)A

GARD JAMESON
& GUESTS

LIVING AS IN THE PRESENCE OF GOD

(Janss
Capacity 75)

A panel discussion with Gard, Reverend Bill Scheeley, a Southern Baptist, and Anuttama Das, a Hare Krishna. 1)L; 2)AP/Panel; 3)A

4:45-5:45

LIVING AS IN THE PRESENCE OF GOD

WILL WENTWORTH

MAKING THE EFFORT

(Anderson
Capacity 300)

A series of short pieces, each followed by audience participation. The main focus will be to distinguish between being alone with God, and being with other people in the presence of God so as to suggest stimuli to action. 1)MD; 2)AP/L; 3)A

ADRIENNE
JARNIGAN

GOD'S UNDERGRADUATES

(Hoaglund
Capacity 300)

Emphasis is on LIVING THE SPIRITUAL LIFE, NOW! in this workshop. The stages in human progress will be discussed as well as cooperation with the Divine Urges versus the Human Struggle. The results of very good intellect and hard work and the results of finding God and TRYING to do His will. 1)L/MD/H; 2)E/AP; 3)A

ARLENE & BUCK
WEIMER

EVERYTHING YOU ALWAYS WANTED TO KNOW ABOUT FAMILY PEACE!

(Erickson/Carroll
Capacity 175)

From conflict to peace through the balance of self and selfless needs. Parental unity versus uniformity, male/female issues, discipline techniques, shame versus self-respect, reversion and work, conflict versus resolution. 1)L; 2)AP; 3)F/A

AVI DOGIM,
LUCILE FAW, CINDY
HOPPER, GERI
JOHNSON
(Janss) Capacity 75

THE SOCIAL RESPONSIBILITY OF SONSHIP

Panel discussion with Lucile Faw, Cindy Hopper, Geri Johnson. If each of us lives his/her life with a constant awareness of sonship, what may be some of the social consequences of this attitude? How may it affect, for example, our organizational behavior? 1)MD; 2)L; 3)A

THURSDAY

**WALKING WITH GOD AND INCORPORATING THE HABITS
WHICH FAVOR RELIGIOUS GROWTH**

9:15-10:00

Program Begins (Anderson Ballroom - Capacity 1200)

Closing Ceremonies

Arts Presentation

10:00-10:45

Plenary Session

LARRY MULLINS

WALKING WITH HUMANKIND

10:45-11:45

BOULDER WOMEN'S CORPS Thanksgiving Worship Service

12:00

Conference Ends

ADDITIONAL COMMON INTEREST GROUPS

TIME	LOCATION	EVENT	SPONSOR/LEADER
<u>SUNDAY:</u>			
1:00-3:00	Janss Auditorium (CC)	Spiritual Spectrum TV Series: One-hour video Program	Julio Edwards
1:00-3:00	Max Park Room (W)	12-Step Meetings (AA, Alanon, CODA, ACA)	D. Johnson
1:00-3:00	Colorado (MC)	Gawryn - Rehearsal	Francyl Gawryn
1:00-3:00	Daly (MC)	Parents' Meeting/Co-op Babysitting	Linda McNelly
<u>MONDAY:</u>			
1:00-3:00	Hoaglund Room (CC)	Women: What is "Spiritual Leadership" (938:8) (Panel Discussion)	Judy Mace
1:00-3:00	Janss Auditorium (CC)	Spiritual Spectrum TV Series: 3 one-hour videos	Julio Edwards
1:00-2:00	Max Park Room (W)	ACOA (Adult Children of Alcoholics)	Paul Mazy
2:00-3:00	Max Park Room (W)	Meditation Workshop for Beginners	Judy Nyland
1:00-3:00	Carroll Room (CC)	Men: Fathers, Sons, Brothers - A Heart-to-Heart Caucus	Eric Johnson
1:00-3:00	Sinclair Room (CC)	Through Conflict to Coordination	Char Moore-Sneve
<u>TUESDAY:</u>			
12:30-2:30	Janss Auditorium (CC)	Spiritual Spectrum TV Series: 3 one-hour videos	Julio Edwards
2:30-3:00	Janss Auditorium (CC)	Video - Toward A Governed World	Byron Belitsos
1:00-3:00	Carroll Room (CC)	Open Forum: Trials and Triumphs in the Healing Arts (Discussion for health professionals, others also welcome)	Steven Hecht
1:00-3:00	Daly Room (MC)	Publications Committee Meeting	
1:00-2:00	Colorado (MC)	Gawryn Rehearsal	Francyl Gawryn
<u>WEDNESDAY:</u>			
12:30-2:30	Janss Auditorium (CC)	Spiritual Spectrum TV Series: 3 one-hour videos	Julio Edwards
2:30-3:00	Janss Auditorium (CC)	Video - Toward A Governed World	Byron Belitsos
1:00-3:00	Carroll Room (CC)	Synthetic Mind: The Computer of Human Technology (Presentation and Group Discussion)	Dieter Weller
1:00-3:00	Erickson Room (CC)	Mental Health Practitioners and The Urantia Book: A sharing of experiences regarding use of the book and concepts in helping the mentally ill	Paul Anderson
1:00-2:00	Colorado (MC)	Gawryn Rehearsal	Francyl Gawryn

CC: Conference Center; W: Hotel Wildwood; MC: Mountain Chalet